



## Installation Instructions for aera® 760 Panel Dock®

Revision 1, October 30, 2020

AD-ISPD031-001



Thank you for purchasing an AirGizmos Panel Dock. This mount was designed to securely hold your portable electronic device. It allows you to quickly remove your portable device for upgrades, flight planning, or for use in another aircraft. We also feel that this is a safer way to use your portable equipment, as it is securely held in the panel at all times. We hope you receive years of enjoyment from our product. Before beginning the installation process, please take a moment to fill out the registration card.

The Panel Dock has been shipped with two sets of mounting hardware. One to attach the cable assembly and the other for attaching the Panel Dock to an avionics stack or side rails. If you intend to install it in a different way, use the included hardware as a reference when deciding what type of installation hardware you will need. The hardware included is as

follows: HW4 kit - 4 AN365-832A ELASTIC LOCK NUTS, 4 AN525-832R8 SCREWS, and 4 AN960-8 FLAT WASHERS. HW4-R10 kit - 4 AN365-832A ELASTIC LOCK NUTS, 4 AN525-832R10 SCREWS, and 4 AN960-8 FLAT WASHERS.

A word of caution: we have designed the mount to be installed using standard screws and we have fabricated the flanges to allow clearance of the screw heads. Please do not attempt to use countersunk screws. Counter-sinking plastic is generally not a good idea, and we cannot guarantee that our product will perform its duty if you choose to countersink the holes. Also, do not use Loctite®, or similar adhesive products for additional security of the screws, it will have a negative effect on plastic. Use the included hardware, or something similar, and everything will be fine. Let's get started.

### Step 1: Prepare a hole in your panel

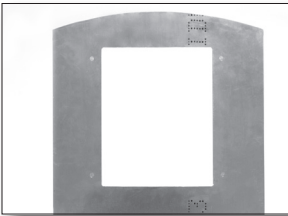

The dimensions of the aera 760 Panel Dock are on the Product Specification sheet which is included with the product and can be downloaded from the AirGizmos website. It is suggested you also measure your Panel Dock and opening to be consistent and safe.

Note: if you are installing this product within a Garmin avionics stack, you may have 6.3" wide trays. To account for the difference, it is acceptable to use washers. One thin washer on each bolt should work just fine.

### Step 2: Temporarily attach mounting rails to the Panel Dock

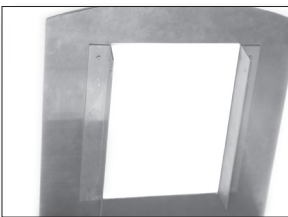

These instructions show the use of rails which are spaced similar to standard radio stack, but that is not the only way to install it. The only requirement for installation is that you must attach the side flanges to side supports spaced the correct distance apart. Two pieces of 1" 6061 aluminum angle works well. Position your rails as desired, making sure they are the proper distance apart, and parallel to each other. You can rivet the rails to the front panel or choose to attach the rails by aircraft quality (AN type) hardware. Either method works well.

### Step 3: Test-fit the Panel Dock

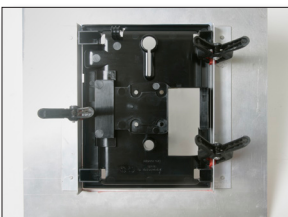

Position the Panel Dock in your panel. This will allow you to determine how it should look from the front before you drill any holes. At this point you should make any adjustments to the rails in order to have your GPS properly positioned in the panel.

#### Step 4: Verify the look and function of the mount



With the Panel Dock secured with the edge clamps you can verify that it is at the correct depth and fits to your liking.

#### Step 5: Mark the holes for drilling

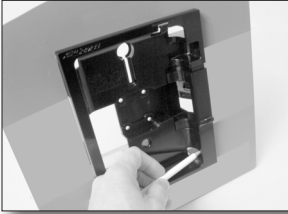

Remove one edge clamp at a time and mark the position of each hole with a pen. Use a circular motion to mark the outer edges of the hole. This will make it easier to determine the exact center.

Do this for all four holes, replacing the edge clamps as you go.

#### Step 6: Drill the holes

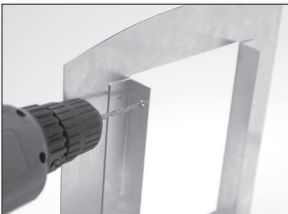

There are a number of ways in which you may choose to drill the holes. You can remove the rails from the panel and drill them on a drill press, or you may use an angle drill to drill them in the aircraft. Just be careful to make accurate holes at the marks you made, and you should be fine.

#### Step 7: Mount the Panel Dock using the supplied hardware

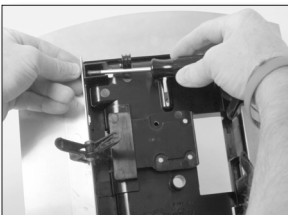

The screws we provide have an integral washer on the screw-head side. This provides adequate distribution of force on the plastic to keep it from cracking. Position the hardware so the screw head is located on the plastic side and the nut is on the outer side of the metal rail. Please, be sure not to over tighten the screws, for this may result in cracking of the plastic of the Panel Dock.

**Vent Tube:** The vent tube can be plumbed for an avionics cooling fan.

#### Step 8: Install the provided Mounting Bracket into the Panel Dock

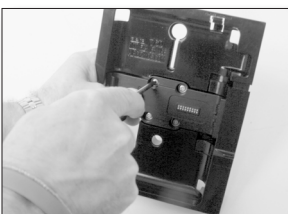

Using the HW4-R10 kit, attach the wiring bracket that came with the GPS to the inside of the Panel Dock. Tight securely but **do not over tighten the screws** - this may result in cracking of the bracket.

Important: Test the release mechanism before installing the GPS unit. The correct position of the mounting bracket is essential for proper operation.

#### Step 9: Insert the GPS and attach cables



To install your GPS into the dock, gently snap it into place in the Mounting Bracket. After inserting, make sure the release lever is in the up position to keep the GPS in place.

**On/Off / Brightness lever (top):** Turn the aera 760 GPS on/off and adjust brightness of the screen while the unit is in the Panel Dock.

**Release lever (bottom):** To release the GPS, press the lever down and pull the GPS out of the Panel Dock.

Congratulations! Your installation is complete. Please visit our website and submit any questions you might have under Contact Us at [www.airgizmos.com](http://www.airgizmos.com).

1100 Jupiter Road, Suite 110, Plano, TX 75074 • (972) 671-8001